

# KUGLASTA SLAVINA ZA GAS tip KPN ...DP

## PRIRUBNIČKA

### DN15 – 50 PN6 – 40

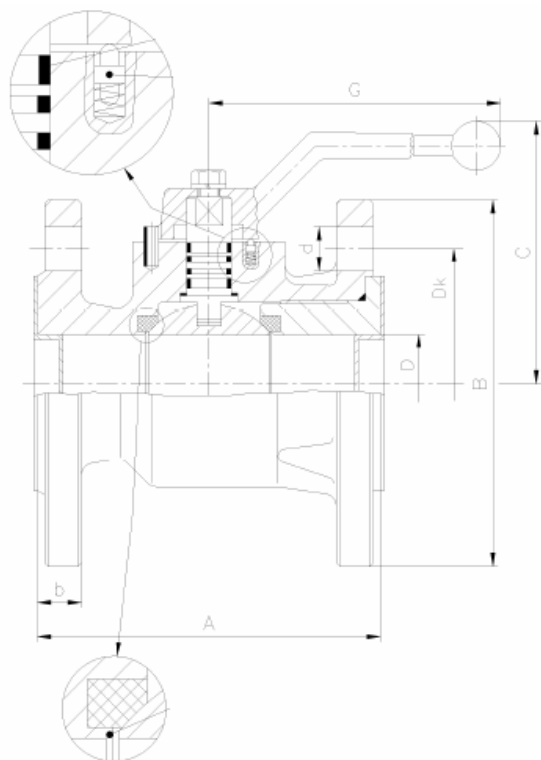

Ugradna dužina: DIN 3202 F18 - kratka  
 Prirubnice: DIN 2541 PN6  
 DIN 2543 PN16  
 DIN 2545 PN40

DN	A	B	D	C	G	b	Dk	d	Št.l.	Težina (kg)
KPN-K15	115	95	13	72	158	16	65	14	4	3,0
KPN-K20	120	105	19,5	82	158	18	75	14	4	3,5
KPN-K25	125	115	25	83	158	18	85	14	4	3,8
KPN-K32	130	140	32	102	180	18	100	18	4	5,8
KPN-K40	140	150	40	107	180	18	110	18	4	7,0
KPN-K50	150	165	50	116	222	20	125	18	4	9,4

NAZIV DELOVA	MATERIJAL
KUĆIŠTE	GGG-40
KUGLA	Ms 58 / X5 Cr Ni 18.9
ZAPTIVAČ	PTFE
VRETENO	X 20 Cr13
O-RING	FPM.NBR-Tmax ≤100 °C PTFE-Tmax ≤200 °C
RUČICA	Al Si 8